

# HAMMAR LIFEBOUOY RELEASE SYSTEM

## IF IT SAVES JUST ONE LIFE, IT'S WORTH IT.



**HAMMAR<sup>®</sup>**  
BETTER SOLUTIONS FOR SAFETY AT SEA

# LIFEBUOY RELEASE SYSTEM

## – A SAFE AND QUICK WAY TO SAVE LIVES

**The time it takes to launch a lifebuoy can be the difference between life and death, when someone falls overboard from a ship or vessel. The Hammar Lifebuoy Release System can be released quickly and safely from any point onboard.**

Most lifebuoys are installed in a holder on the bridge wing or a similarly remote location, to which access may take time. The Hammar Lifebuoy Release System is a complete, easy-to-fit package for the rapid launch of lifebuoys onboard a ship. It fits ships, vessels and workboats of all types. There is one version for electronic remote release as well as one for manual release. When the system is activated, a stainless steel lever is

removed by a strong spring in order to ensure the safe, rapid deployment of the system. The GRP holder is double-sided and can therefore be mounted on either the starboard or port side.

For a ship yard, the system offers easy installation and trouble-free sourcing, as all parts are delivered in a complete package. The system is cost-effective, not only because it saves time but, more importantly, it may even save lives.

### **Special features:**

- Safe and quick operation to save lives
- Electric activation from the bridge
- One complete package
- Easy and quick installation onboard
- Economical solution



# HOW DOES IT WORK?

Using the Hammar Lifebuoy Release system is easy. Just push the button, the ERU activates and the stainless steel lever is removed by a strong spring in order to ensure the safe, rapid deployment of the system.

## The Hammar Lifebuoy System Mk II consists of:

- GRP holder with metal spring holder and manual backup
- Hammar ERRS remote activation package

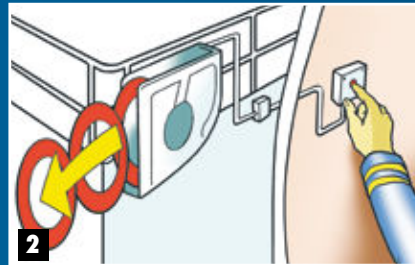

*MOB signal can be mounted. When mounting, please follow the mounting instructions from the MOB manufacturer.*



## LIFEBUOY SYSTEM COMPONENTS

### Part no. HM-0600

#### Lifebuoy System Mk II complete package for electric remote release

- GRP holder with pre-installed metal holder and bracket
- ERU (electric remote unit) with cord pre-installed on metal holder
- Release switch
- Connector box
- 20m cable from connector box to release switch, screened 2 x 0.75 mm<sup>2</sup>, diameter 8 mm
- Manual safety pin
- Pilot line for loading the lifebuoy
- Installation manual
- User Guide
- Marking instruction

Not supplied in the kit from CM Hammar: Lifebuoy, mounting bolts for the installation onboard.

### Part no. HM-0610

#### Lifebuoy System Mk II complete package for manual release only

- GRP holder, metal spring holder, manual safety pin, release cord and installation manual in English.

Not supplied in the kit from CM Hammar: Lifebuoy, mounting bolts for the installation onboard.



## SPARE PARTS

### Part no. HM-0620

#### Lifebuoy System metal spring holder only

### Part no. HM-0630

#### Replacement kit lifebuoy system Mk II

ERU electric/water activation, with release cord and installation manual in English. The ERU shall be changed every two years in order to have the same service interval as liferafts and Epirbs.



### Part no. HM-0406

#### Replacement kit lifebuoy system Mk I

ERU electric/water activation, with release cord, metal ring, cable tie and installation manual in English. The ERU shall be changed every two years in order to have the same service interval as liferafts and Epirbs.



Following comprehensive product information may be downloaded at [www.cmhammar.com](http://www.cmhammar.com)

- Lifebuoy Product Information
- Lifebuoy Installation Manual
- BV Attestation

# HAMMAR®

[www.cmhammar.com](http://www.cmhammar.com)